

# OFFICE CONDO SPACES FOR LEASE

880 Lawrence Road, Kemah, Texas 77565

## OFFICE CONDO SPACES AVAILABLE:

LEASE PRICING: \$20.64 SF plus NNN

Three (3) Suites available or contiguous!

Suite 182 – 1,400 SF

Suite 186 – 1,000 SF

Suite 188 – 1,400 SF

Combined Suites 186-188 – 2,400 SF

Combined Suites 182, 186 & 188 – 3,800 SF

**ALL SPACES AVAILABLE BY AUGUST 1<sup>st</sup>**

### Features:

- Each space has its individual entry
- Single story first floor space
- 10' ceiling heights
- Well insulated quiet concrete walls
- Hurricane glass windows
- Wired for high-speed internet
- Market area includes major retailers such as Target, Walmart, Home Depot, Marshalls, Ross, Office Depot, and many more
- Close to the Kemah Boardwalk and other major attractions, such as Johnson Space Center
- Entire complex is managed by the Lawrence Business Park POA



880 LAWRENCE ROAD

[www.RutledgeCommercial.com](http://www.RutledgeCommercial.com)

PO Box 580332

Houston, TX 77258

FOR MORE INFORMATION CONTACT:

Wayne Rutledge

[Wayne@RutledgeCommercial.com](mailto:Wayne@RutledgeCommercial.com)

832-875-2980

This information contained herein was obtained from sources believed reliable; however, Rutledge Commercial makes no guarantees, warranties, or representations as to the completeness or accuracy thereof. The presentation on this property is submitted subject to errors, omission, changes of price, or conditions, prior to sale or lease, or withdrawal without notice.





# OFFICE CONDO SPACES FOR LEASE

880 Lawrence Road, Kemah, Texas 77565



880 Floor Plan

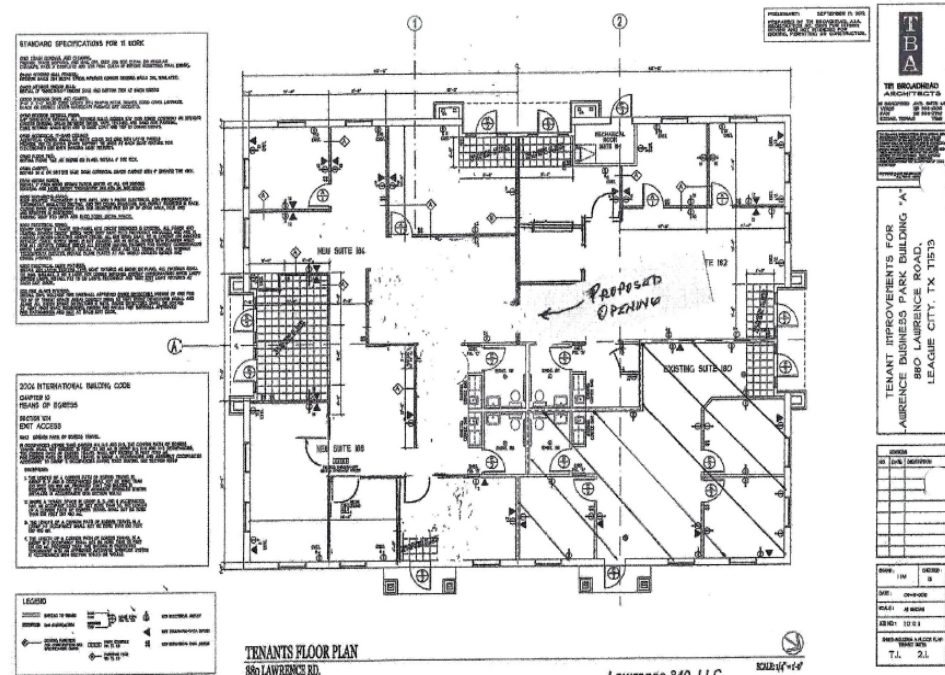

Conveniently located near Kemah Boardwalk!

Lawrence 840, LLC  
957 NASA Pkwy, #563  
Houston, TX 77058

DEC 2 1 2022



[www.RutledgeCommercial.com](http://www.RutledgeCommercial.com)

PO Box 580332  
Houston, TX 77258

FOR MORE INFORMATION CONTACT:  
Wayne Rutledge  
[Wayne@RutledgeCommercial.com](mailto:Wayne@RutledgeCommercial.com)  
832-875-2980

This information contained herein was obtained from sources believed reliable; however, Rutledge Commercial makes no guarantees, warranties, or representations as to the completeness or accuracy thereof. The presentation on this property is submitted subject to errors, omission, changes of price, or conditions, prior to sale or lease, or withdrawal without notice.

# OFFICE CONDO SPACES FOR LEASE

880 Lawrence Road, Kemah, Texas 77565

880 Lawrence Road  
Kemah, Texas 77565



## Information About Brokerage Services

Texas law requires all real estate licensees to give the following information about brokerage services to prospective buyers, tenants, sellers and landlords.

11/2/2015

### TYPES OF REAL ESTATE LICENSE HOLDERS:

- A **BROKER** is responsible for all brokerage activities, including acts performed by sales agents sponsored by the broker.
- A **SALES AGENT** must be sponsored by a broker and works with clients on behalf of the broker.

### A BROKER'S MINIMUM DUTIES REQUIRED BY LAW (A client is the person or party that the broker represents):

- Put the interests of the client above all others, including the broker's own interests;
- Inform the client of any material information about the property or transaction received by the broker;
- Answer the client's questions and present any offer to or counter-offer from the client; and
- Treat all parties to a real estate transaction honestly and fairly.

### A LICENSE HOLDER CAN REPRESENT A PARTY IN A REAL ESTATE TRANSACTION:

**AS AGENT FOR OWNER (SELLER/LANDLORD):** The broker becomes the property owner's agent through an agreement with the owner, usually in a written listing to sell or property management agreement. An owner's agent must perform the broker's minimum duties above and must inform the owner of any material information about the property or transaction known by the agent, including information disclosed to the agent or subagent by the buyer or buyer's agent.

**AS AGENT FOR BUYER/TENANT:** The broker becomes the buyer/tenant's agent by agreeing to represent the buyer, usually through a written representation agreement. A buyer's agent must perform the broker's minimum duties above and must inform the buyer of any material information about the property or transaction known by the agent, including information disclosed to the agent by the seller or seller's agent.

**AS AGENT FOR BOTH - INTERMEDIARY:** To act as an intermediary between the parties the broker must first obtain the written agreement of each party to the transaction. The written agreement must state who will pay the broker and, in conspicuous bold or underlined print, set forth the broker's obligations as an intermediary. A broker who acts as an intermediary:

- Must treat all parties to the transaction impartially and fairly;
- May, with the parties' written consent, appoint a different license holder associated with the broker to each party (owner and buyer) to communicate with, provide opinions and advice to, and carry out the instructions of each party to the transaction.
- Must not, unless specifically authorized in writing to do so by the party, disclose:
  - o that the owner will accept a price less than the written asking price;
  - o that the buyer/tenant will pay a price greater than the price submitted in a written offer; and
  - o any confidential information or any other information that a party specifically instructs the broker in writing not to disclose, unless required to do so by law.

**AS SUBAGENT:** A license holder acts as a subagent when aiding a buyer in a transaction without an agreement to represent the buyer. A subagent can assist the buyer but does not represent the buyer and must place the interests of the owner first.

### TO AVOID DISPUTES, ALL AGREEMENTS BETWEEN YOU AND A BROKER SHOULD BE IN WRITING AND CLEARLY ESTABLISH:

- The broker's duties and responsibilities to you, and your obligations under the representation agreement.
- Who will pay the broker for services provided to you, when payment will be made and how the payment will be calculated.

**LICENSE HOLDER CONTACT INFORMATION:** This notice is being provided for information purposes. It does not create an obligation for you to use the broker's services. Please acknowledge receipt of this notice below and retain a copy for your records.

<u>Rutledge Real Estate, LLC</u>	<u>9005660</u>	<u>wayne@rutledgecommercial.com</u>	<u>(281)957-7980</u>
Licensed Broker /Broker Firm Name or Primary Assumed Business Name	License No.	Email	Phone
<u>Wayne Rutledge</u>	<u>574582</u>	<u>wayne@rutledgecommercial.com</u>	<u>(832)875-2980</u>
Designated Broker of Firm	License No.	Email	Phone
<u>Wayne Rutledge</u>	<u>574582</u>	<u>wayne@rutledgecommercial.com</u>	<u>(832)875-2980</u>
Licensed Supervisor of Sales Agent/ Associate	License No.	Email	Phone
<u>Laurie Rutledge</u>	<u>671487</u>	<u>Laurie@rutledgecommercial.com</u>	<u>(832)641-9103</u>
Sales Agent/Associate's Name	License No.	Email	Phone

Buyer/Tenant/Seller/Landlord Initials \_\_\_\_\_ Date \_\_\_\_\_

Regulated by the Texas Real Estate Commission

Information available at [www.trec.texas.gov](http://www.trec.texas.gov)  
IABS 1-0 Date \_\_\_\_\_ Forms \_\_\_\_\_

Rutledge Real Estate, P. O. Box 58066 Houston, TX 77258  
Laurie Rutledge

Phone: 2819577980 Fax: \_\_\_\_\_  
Produced with zipForm® by zipLogix 18070 Fifteen Mile Road, Fraser, Michigan 48026 [www.zipLogix.com](http://www.zipLogix.com)

[www.RutledgeCommercial.com](http://www.RutledgeCommercial.com)

PO Box 580332  
Houston, TX 77258

FOR MORE INFORMATION CONTACT:  
Wayne Rutledge  
[Wayne@RutledgeCommercial.com](mailto:Wayne@RutledgeCommercial.com)  
832-875-2980

This information contained herein was obtained from sources believed reliable; however, Rutledge Commercial makes no guarantees, warranties, or representations as to the completeness or accuracy thereof. The presentation on this property is submitted subject to errors, omission, changes of price, or conditions, prior to sale or lease, or withdrawal without notice.

